

MARK	ROOM	TYPE	SIZE ROUGH OPENING		MATERIALS & FINISHES			HARDWARE	DETAILS		PHASING	NOA
			WIDTH	HEIGHT	PANEL	FRAME	FINISH		HEAD	JAMB		
			3' - 0"	6' - 8"	ALUMINUM	ALUMINUM	PAINT		A2/A2.0	A3/A2.0		
101	ENTRY	Door-Passage-Single-Flush	3' - 0"	6' - 8"	ALUMINUM	ALUMINUM	PAINT	LOCKSET	A2/A2.0	A3/A2.0	New	10-1102.19
102	BEDROOMS	Door-Passage-Single-Flush	2' - 8"	6' - 8"	WOOD	WOOD	PAINT	LOCKSET	A2/A2.0	A3/A2.0	New	-
103	BATHROOMS	Door-Passage-Single-Flush	2' - 6"	6' - 8"	WOOD	WOOD	PAINT	LOCKSET	A2/A2.0	A3/A2.0	New	-
104	M. BED CLOSET	Door-Bi-Fold-Single-Flush	2' - 6"	6' - 8"	WOOD	WOOD	PAINT	LOCKSET	A2/A2.0	A3/A2.0	New	-
105	BED #1 CLOSET / DEN CLOSET	Door-Bi-Fold-Double-Flush	4' - 0"	6' - 8"	WOOD	WOOD	PAINT	LOCKSET	A2/A2.0	A3/A2.0	New	-
106	LAUNDRY CLOSET	Door-Bi-Fold-Double-Flush	6' - 0"	6' - 8"	WOOD	WOOD	PAINT	LOCKSET	A2/A2.0	A3/A2.0	New	-
107								LOCKSET	A2/A2.0	A3/A2.0	New	-

SAFETY NOTES FOR DOORS
EXISTING AND NEWWORK
 NFPA 70 - 1999 CHAPTER 21
 (21-1.4.1) EXISTING CLOSET DOOR LATCH SHALL BE SUCH THAT CHILDREN CAN OPEN THE DOOR FROM INSIDE THE CLOSET
 (21-1.4.1) EXISTING BATHROOM DOOR LATCH SHALL BE DESIGNED TO PREVENT THE OPENING OF THE LOCKED DOOR FROM THE OUTSIDE IN AN EMERGENCY
 EXISTING DOOR TYPE OF LOCK OR LATCH MUST COMPLY WITH FC R310.4.4

WINDOW SCHEDULE																
UNIT A & UNIT B																
TYPE	SIZE WIDTH x HEIGHT	ROUGH OPENING WIDTH x HEIGHT	REQUIRED PRESSURES		APPROVED PRESSURES		PRODUCT APPR. NUMBER	MATERIAL		GLAZING MATERIAL (TYPE)			FASTENER SPACING			REMARKS
			POS / NEG	POS / NEG	POS / NEG	POS / NEG		EXTERIOR	INTERIOR	HEAD	JAMB	HEAD	JAMB	SILL	TYPE	
(3) SINGLE HUNG	37" x 59"	37" x 59"	+75 / -90.0	+41.45/-54.13	15-0802.06	Aluminum	Aluminum	Tinted/ Impact Protection	TYPE A	C3 / 4.0	C3 / 4.0	1/4" x 3/8"	1/4" x 3/8"	1/4" x 3/8"	1/4" x 3/8"	RESISTIVE WINDSTOPPING W/IMPACT SAFETY GLASS
(4) SINGLE HUNG	37" x 26"	37" x 26"	+75 / -90.0	+40.09/-51.46	15-0802.06	Aluminum	Aluminum	Tinted/ Impact Protection	TYPE A	C3 / 4.0	C3 / 4.0	1/4" x 3/8"	1/4" x 3/8"	1/4" x 3/8"	1/4" x 3/8"	RESISTIVE WINDSTOPPING W/IMPACT SAFETY GLASS
(2) SINGLE HUNG	37" x 38 3/8"	37" x 38 3/8"	+75 / -90.0	+43.45/-47.13	15-0802.06	Aluminum	Aluminum	Tinted/ Impact Protection	TYPE A	C3 / 4.0	C3 / 4.0	1/4" x 3/8"	1/4" x 3/8"	1/4" x 3/8"	1/4" x 3/8"	ATTACHED W/IMPACT SAFETY GLASS
(1) FIX WINDOWS	37" x 72"	37" x 72"	+75 / -90.0	+43.45/-47.13	17-1011.20	Aluminum	Aluminum	Tinted/ Impact Protection	TYPE A	C3 / 4.0	C3 / 4.0	1/4" x 3/8"	1/4" x 3/8"	1/4" x 3/8"	1/4" x 3/8"	STAIRWELL SAFETY GLASS
E EXISTING TO REMAIN																

NOTES:
 1- ALL GLASS SHALL BE CLEAR
 2- TINTED GLASS (SAFETY GLASS CATEGORY CLASS 2)
 3- GREEN TINT
 4- SH (SINGLE HUNG)
 WINDOW GLASS: U-FACTOR 0.45 / SHGC 0.25 RATED AS PER FBC 2014

FLOOR PLAN LEGEND

- HATCHED AREA TO NEW WORK
- AREA NO NEW WORK PROPOSED, EXISTING TO REMAIN (NOT HATCHED)
- NOT PART OF THIS PERMIT (HATCHED AREA)
- EXISTING TO BE DEMOLISHED
- MASONRY WALLS
- NEW PARTITION WALLS
- NEW LOW PARTITION WALL

- WALL TYPE TAG E EXISTING
- EXT'G. DOOR N NEW
- EXT'G. WINDOW R REPLACE/RELOCATE
- DOOR TAG
- WINDOW TAG
- DUPLEX RECEPTACLE ABOVE COUNTER
- GFCI OUTLET
- RECEPTACLE, 120V, 20A, DEDICATED
- TELEPHONE OUTLET
- SWITCH
- DIMMER SWITCH
- 3 WAY SWITCH
- J-BOX ELECTRICAL OUTLET
- ELECTRICAL PANEL
- THERMOSTAT
- DISCONNECT SWITCH

REQUIRED 1 HOUR FIRE RATED SEPARATION BETWEEN UNITS, PER ASTM E 119 OR UL 263, FBC R302.3.1 SEE DETAILS #11 & #2 NO SHEET SP-1.0

GLASS NOTE: SLIDING DOOR AT BATHROOM SHOWER SHALL BE SAFETY GLASS CAT II FBC R308.3.1

NOTE: EXTERIOR DOORS & WINDOWS, ROOF TRUSSES, ROOFING SHINGLES, DRIVEWAY AND FENCE UNDER SEPARATE PERMIT WITH THE SUB-CONTRACTORS

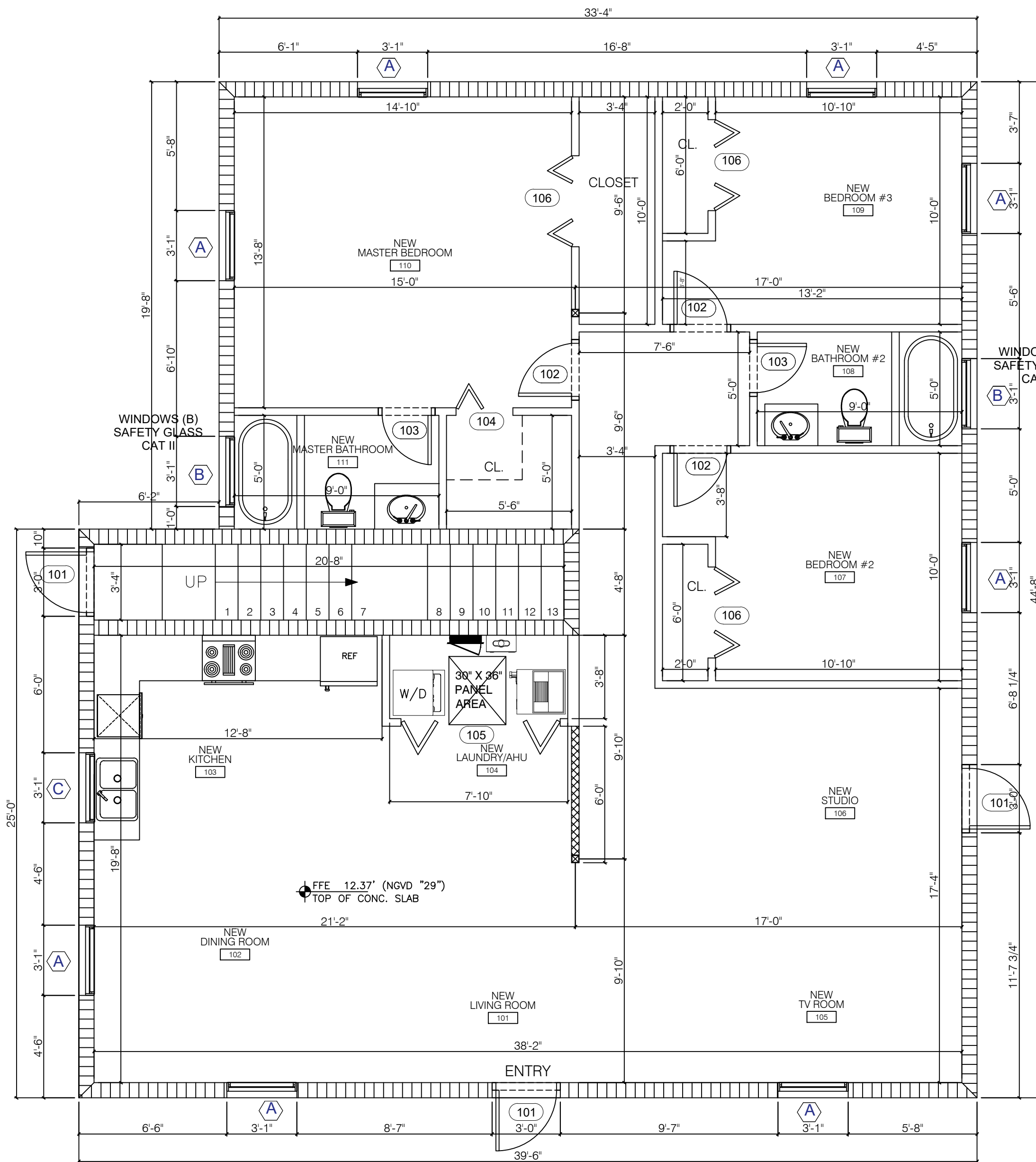

A1 1ST FLOOR PLAN
SCALE: 1/4" = 1'-0"

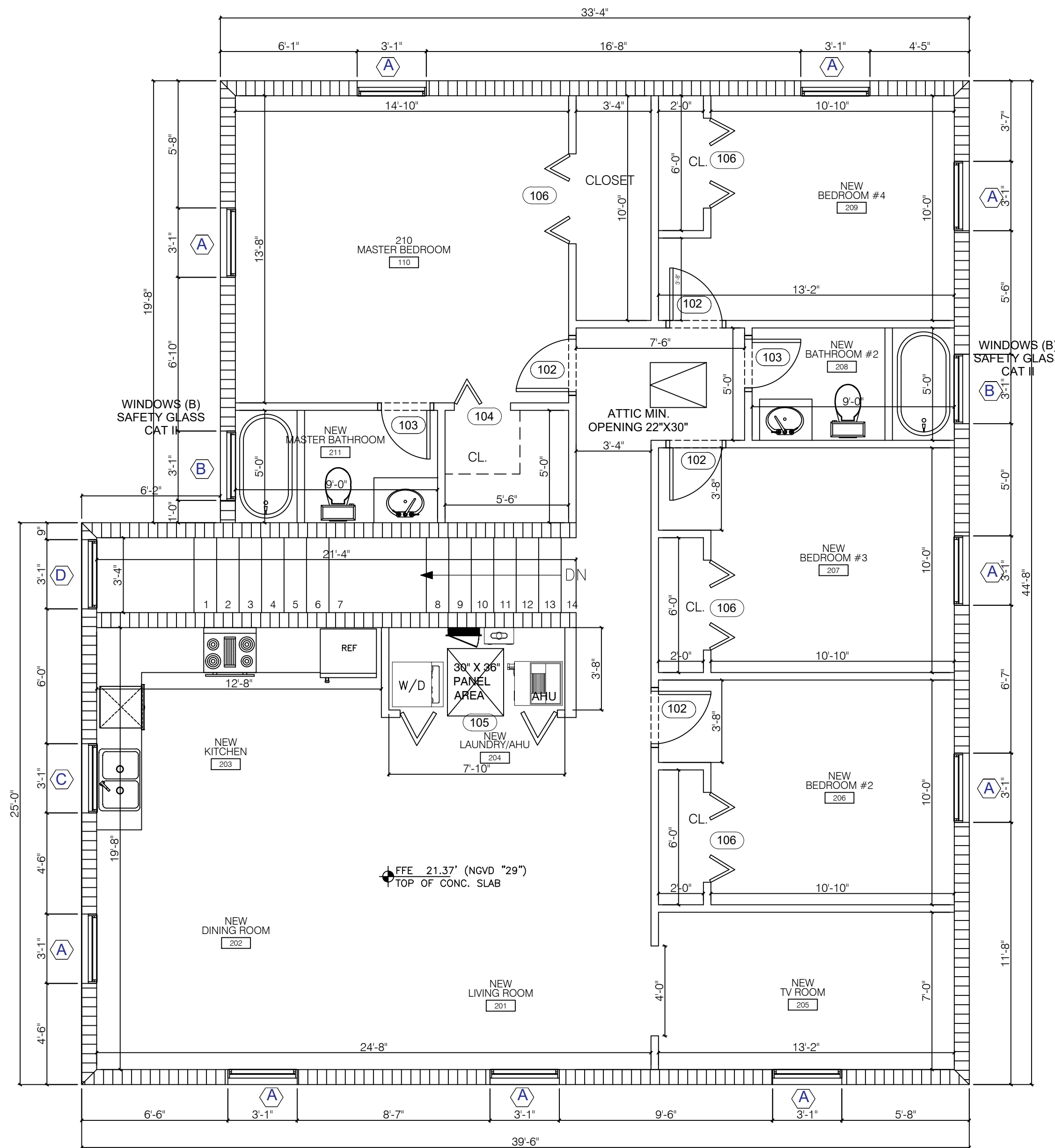

A2 2ND FLOOR PLAN
SCALE: 1/4" = 1'-0"



Project Title:

This Sheet:

REVISIONS

NO.	DESCRIPTION

DESCRIPTION

Date:
Drawn By:

Approved By:

SEAL

SHEET NO.

A-1.0

04 21

SANTIAGO BOLLIVAR, P.E.
 CONSULTING ENGINEER
 FL LIC No. 53326
 265 S. FEDERAL HWY # 453
 DEERFIELD BEACH, FL 33441
 TEL: (786) 571-9603

New Duplex
Two Story Residence
1035 N.W. 75 Street
Miami, FL 33150

Floor Plan

THESE DRAWINGS AND DESIGNS ARE THE PROPERTY OF SANTIAGO BOLLIVAR, P.E. AND SHALL BE REPRODUCED WITHOUT HIS WRITTEN CONSENT.