

LEGEND

- EXISTING GRADES
- PROPOSED GRADES
- DIRECTION OF DRAINAGE

SITE INFORMATION

SITE CALCULATIONS

ZONING & COVERAGE PERCENTAGES :

NET LAND AREA :	5500QFT	1000
FOOTPRINT (UNDER ROOF) :	2262.00SQFT	

DRIVES & WALKS :	1058.33SQFT	
------------------	-------------	--

TOTAL IMPERVIOUS AREAS :	3320.33 SQFT	60.37%
GREEN AREA	2179.67 SQFT	39.63%

DRAINAGE CAPACITY CALCULATIONS

SITE SHALL RETAIN 1" RUNOFF OVER ENTIRE SITE OR 2 1/2" OVER IMPERVIOUS AREAS (WHICHEVER IS GREATER)

5500 SQFT X 0.0833 IN/CU FT.	=458 CU.FT (N/A)
3320.33 SQFT X 0.2083 IN/CU FT.	=691 CU.FT (REQUIRED)

SWALE 'A'	=700CU.FT (PROVIDED)
700 C.F.T. OF RETENTION PROVIDED	

NOTE: MATCH EXISTING GRADE ELEVATIONS OF ADJACENT PROPERTIES
DRIVE WAY TYSWALE SECTION RETENTION SECTIONS

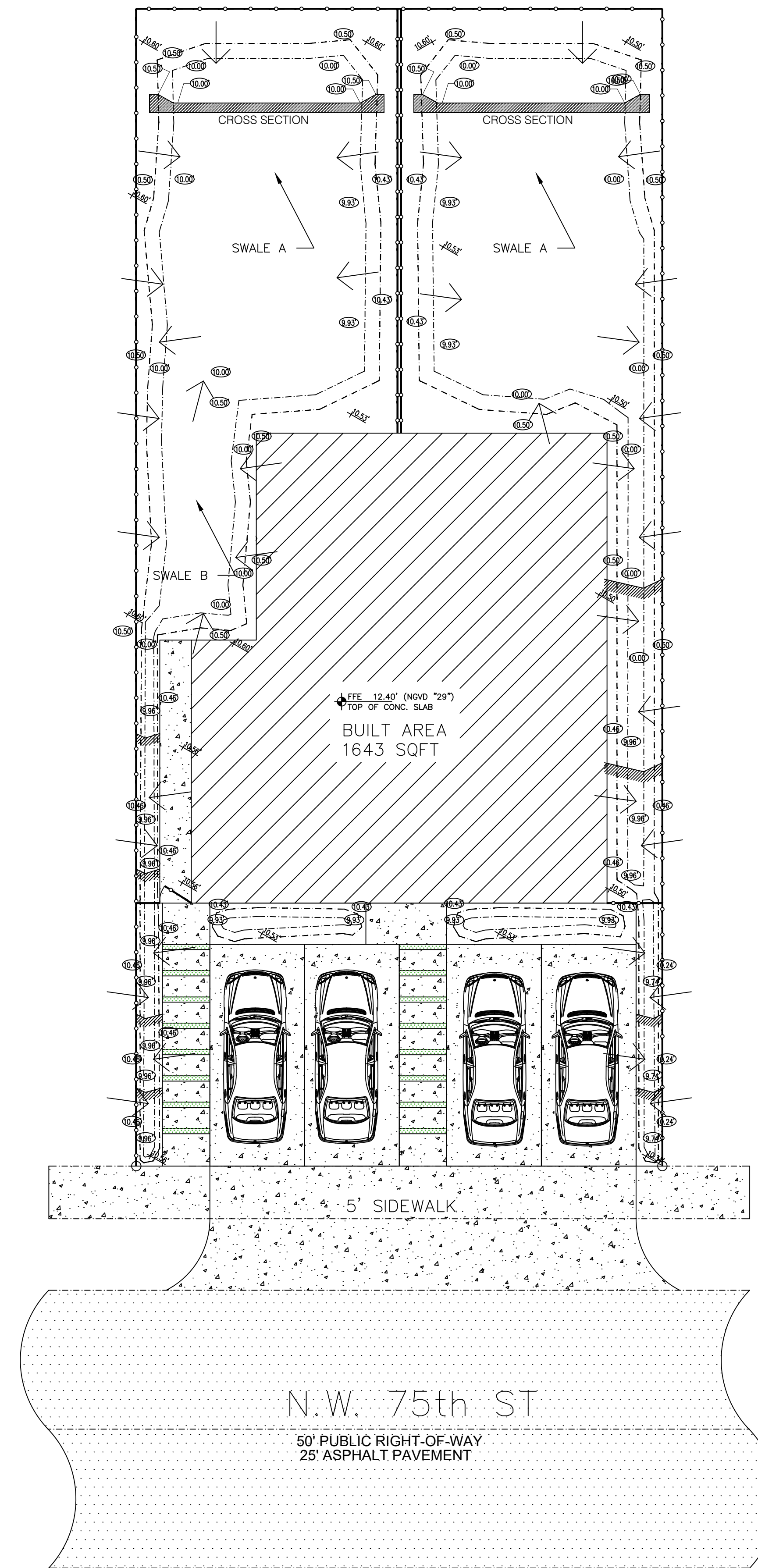
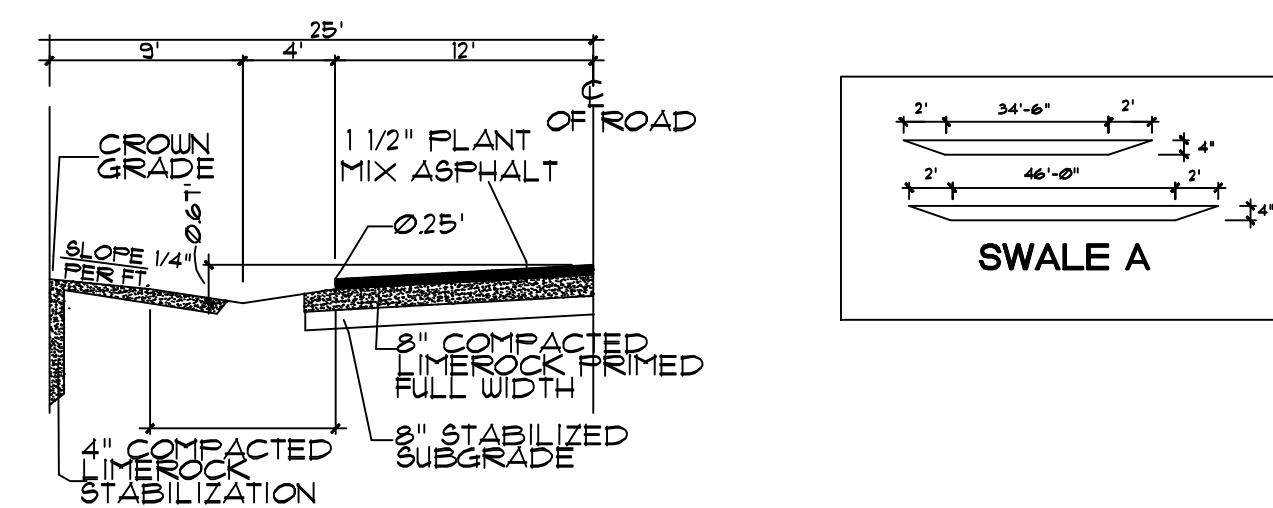

DR DRAINAGE PLAN
SCALE: 1/8" = 1'-0"



SANTIAGO BOLLIVAR, P.E.
CONSULTING ENGINEER
FL. LIC. No. 53326
265 S. FEDERAL HWY # 453
DEERFIELD BEACH, FL. 33441
TEL: (786) 571-9603

New Duplex
Two Story Residence
1035 N.W. 75 Street
Miami, fl 33150

Project Title:
Address:

Drainage Plan

REVISIONS

DESCRIPTION

Date:
Drawn By:

Approved By:

SEAL

SHEET NO.

DR-1.0

20 | 21